

logan art gallery

Group Exhibition Proposal Information pack and application form



LOGAN
CITY COUNCIL

The following documents aim to assist potential exhibiting artists by providing clear guidelines about how to apply for an exhibition at Logan Art Gallery. Additional information can be found in the document **TIPS for Producing an Effective Exhibition Proposal**, which is available for download from the website or by contacting the gallery.

Guidelines

Logan Art Gallery accepts proposals all year round from interested artists. Your proposal should reflect the selection criteria (see below). Please note: generally each group may submit only one proposal every two years due to popular demand on exhibition spaces.

Please read the information pack and application carefully. If you require assistance completing your application form, require an interpreter, or would like to discuss your exhibition proposal, please contact the Exhibitions Officer or Cultural Services Program Leader at Logan Art Gallery.

General information

About Logan Art Gallery

Logan Art Gallery is situated on the corner of Wembley Road and Jacaranda Avenue, Logan Central. It comprises five exhibition spaces, a gallery store and a large public programs workshop area and courtyard. The gallery holds exhibitions by local and national artists as well as curated and touring shows. Practical workshops and various public programs including artist floor talks are held over the entire year.

Gallery hours: 10 am - 5 pm, Tuesday to Saturday.

Selection criteria

Proposals are invited from artists that:

- are conceptually refined and able to clearly communicate the exhibition idea/ theme
- are innovative
- are proposing technically resolved works.



Funding information

Logan Art Gallery provides artists with a high quality exhibition space, experienced installation staff and a range of useful equipment. The Gallery also provides a printed invitation to promote exhibitions, written didactics and labels relevant to exhibition artwork, and an exhibition opening event, including catering.

Artists wishing to seek additional support for their exhibition should contact Arts Queensland (<http://www.arts.qld.gov.au/>) or Logan City Council (<http://www.logan.qld.gov.au/community-support/grants/regional-arts-development-fund>) for specific information on the grants available and eligibility requirements.

Installation

The installation and demounting of your work will be carried out by the gallery installation staff. Exhibitions change approximately every six weeks. Installation generally occurs on the Tuesday of installation week, and the official opening is usually held on Friday evenings. This is subject to change at the Gallery's discretion.

Equipment

Logan Art Gallery makes equipment available to artists for their exhibition. This is subject to availability, and the gallery must be notified well in advance. The gallery's equipment includes plinths and display cases, moveable walls, DVD players, data projectors and televisions.

Gallery specifications

Gallery One

Ceiling height: Low point 2.36 m, High point 5.9 m
Running meters: 19.45 m
Power points: 2
Walls: Brick with hanging track, and one plaster wall

Gallery Two

Ceiling height: Low point 3.35 m, High point 5.9 m
Running meters: 32.68 m
Power Points: 3
Walls: Plaster and brick with hanging track

Gallery Three

Ceiling height: Low point 3.35 m, High point 5.9 m
Running meters: 29.96 m
Power points: 4
Walls: Plaster and brick with hanging track

Young People's Gallery

Ceiling height: Low point 3.35 m, High point 5.9 m
Running meters: 8.11 m
Power points: 1
Walls: Plaster with hanging track

Gallery Foyer

Ceiling height: Low point 2.36 m, High point 5.9 m
Running meters: 22.46 m
Power points: 3
Walls: Plaster with hanging track

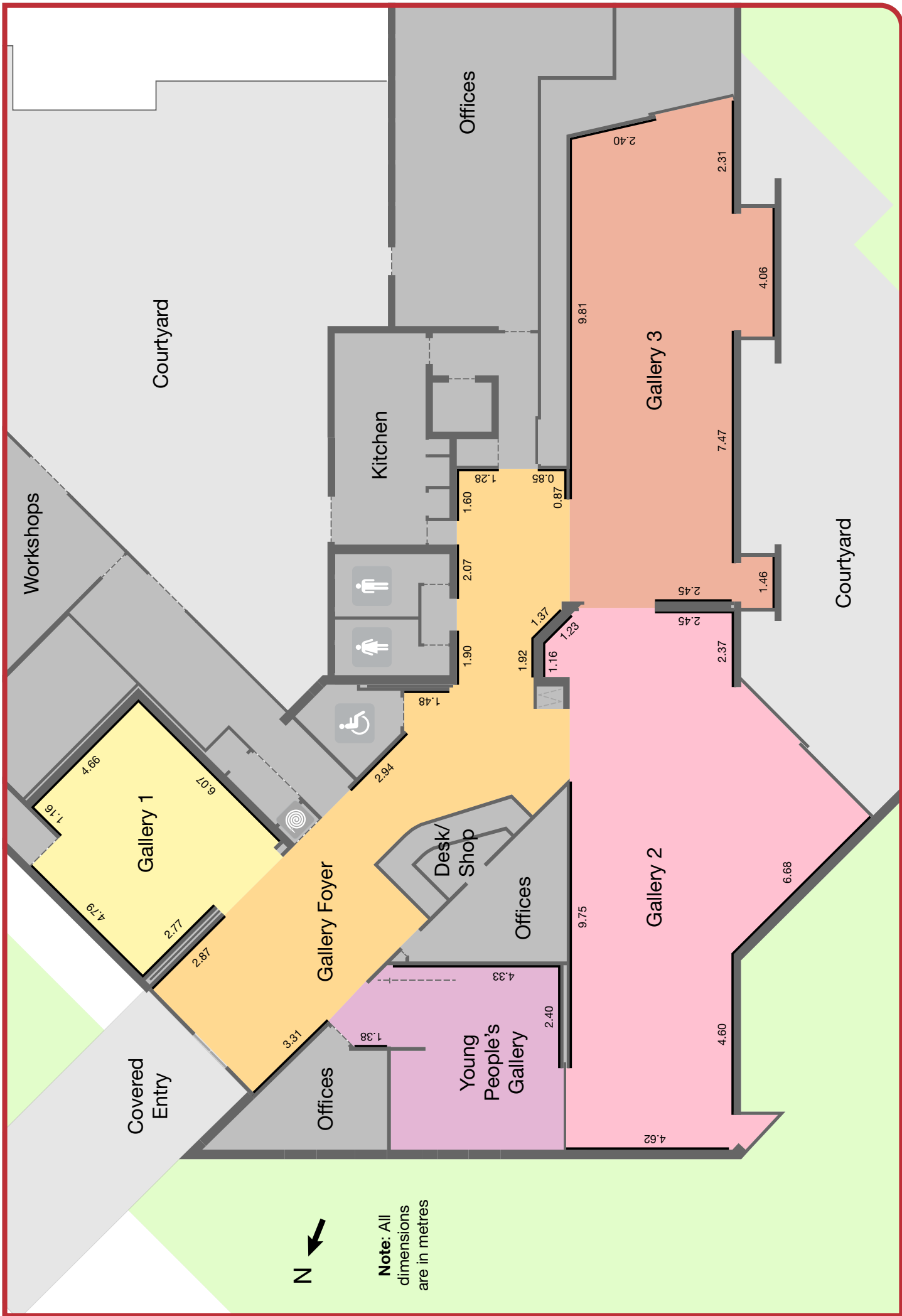

GROUP EXHIBITION PROPOSAL APPLICATION FORM

www.logan.qld.gov.au/artgallery

Page 3 of 5

Personal details of main contact for group

Group name (if applicable)

Key contact name

Address

Telephone

Mobile phone

Email

ABN of the group or key artist

Is the group or key artist registered for GST? Yes

No

(OR please indicate if the group or key artist needs to fill out an ATO Statement by Supplier Form)

Names of participating artists

Exhibition summary

Title of exhibition

Medium/s

Which gallery space are you interested in? Gallery One Gallery Two Gallery Three
 Young People's Gallery Foyer Gallery

Will your work be for sale? Yes No (Please note that the Gallery receives a 20% commission on all sales).

Date exhibition is available

Equipment required

Public programs: Are you interested in conducting any public programs? i.e. floor talk or workshops. Yes No

Project summary: (Briefly describe your project in 80 words)

GROUP EXHIBITION PROPOSAL

EXHIBITION DETAILS

www.logan.qld.gov.au/artgallery

Page 3 of 5

Exhibition concept

The exhibition concept explains your exhibition idea or theme in **200 words or less**.

What is the curatorial link between participating artists? What themes are explored? What is the exhibition about? Why is this group proposing to hold an exhibition?

Artwork description

Please describe in **200 words or less** what your exhibition will contain, and any thoughts about how it might be displayed within the gallery space. For example: *Four photographs of people on bicycles, each 100 x 100 cm installed on rear wall, two sculptures of BMX bikes placed on plinths in centre of room. A video work about BMX racing projected on to left-hand wall.*

GROUP EXHIBITION PROPOSAL SUPPORT MATERIAL

www.logan.qld.gov.au/artgallery

Page 3 of 5

Please include at least one image for each artist **or** no more than one minute of video per artist. Please include examples of artwork indicative of the work that will be included in the exhibition or the proposed work.

- For video works, please provide your work on a playable DVD in one of the following formats: QuickTime, Windows Media, or MPEG4. **ALL** moving images must be submitted on disk. Please indicate this below.
- For still images, please submit them on disk and ensure they are print quality ie. over 1Mb and at least 300dpi. If you are unable to submit digital images, we will accept clearly printed, labelled, in-focus images.
- If you are emailing your application, please attach low resolution images to the email and post a DVD of any moving images. Please indicate this below.

Image details

Image no. or filename	Artist name and title of work	Date	Medium	Dimensions	Photographer	Proposed work or indicative work?
						Proposed <input type="checkbox"/> Indicative <input type="checkbox"/>
						Proposed <input type="checkbox"/> Indicative <input type="checkbox"/>
						Proposed <input type="checkbox"/> Indicative <input type="checkbox"/>
						Proposed <input type="checkbox"/> Indicative <input type="checkbox"/>
						Proposed <input type="checkbox"/> Indicative <input type="checkbox"/>
						Proposed <input type="checkbox"/> Indicative <input type="checkbox"/>
						Proposed <input type="checkbox"/> Indicative <input type="checkbox"/>
						Proposed <input type="checkbox"/> Indicative <input type="checkbox"/>
						Proposed <input type="checkbox"/> Indicative <input type="checkbox"/>
						Proposed <input type="checkbox"/> Indicative <input type="checkbox"/>
						Proposed <input type="checkbox"/> Indicative <input type="checkbox"/>

GROUP EXHIBITION PROPOSAL APPLICANT DECLARATION

www.logan.qld.gov.au/artgallery

Page 5 of 5

This form is an expression of interest only. Logan City Council reserves the right to review works, exhibitions, proposals and submissions in respect to the Logan Art Gallery exhibition program.

I, , have read and completed all the information in this application.

Signature

Date

Further information

If you have any questions or need assistance in completing your application, please contact the Exhibitions Officer:

Exhibitions Officer

Phone: 07 3412 5519

Email: artgallery@logan.qld.gov.au

Returning forms

Please post your Exhibition Proposal to:

Logan Art Gallery
PO Box 3226
Logan City DC QLD 4114

OR

Email your application to:

artgallery@logan.qld.gov.au. If emailing your application please send this PDF and your images. The total of your images and documents must be less than 10 Mb.

Application checklist

- Completed and signed exhibition proposal
- At least one high resolution image per artist on disk **OR** printed **AND/OR** no more than one minute of video per artist on DVD **OR** at least one low resolution image per artist included in your emailed application

Thank you for submitting your group exhibition proposal to Logan Art Gallery.

Your application will not be returned.

Please make a copy of it for your records.

Logan City Council is collecting your personal information in order to be able to assess your proposal and contact you in regards to your exhibition application. This information is available to council staff only. Subject to these disclosures your information will not be given to any other person or agency unless you have given us permission to do so, or we are required by law.

(DM#7253445)

logan art
gallery

